



MICHIGAN LOCATION:
13870 Cavaliere Drive
Shelby Township, MI 48315
586-803-3163

KENTUCKY LOCATION:
2041 Clay Street
Henderson, KY 42420
270-888-7001

Hours Monday-Friday : 8am-5pm EST

PRICES EXPIRE JUNE 30, 2024

Order Online @ www.nextind.com

SA STANDARD ABRASIVES Handy Rolls-Aluminum Oxide

- Commonly used for deburring, cleaning, and polishing
- A necessity in machine and maintenance shops
- May be used with water, water based or oil based coolants that eliminate the costly degreasing of parts before polishing or deburring
- Full resin bond material for wide range of applications and longer lasting



Size	Grit	Mfg. No.	Order No.	Sale Price
1-1/2" x 50 yd	50	051115-37483-8	13062-7010331451	\$38.50
1-1/2" x 50 yd	60	051115-32908-1	13062-7010331446	47.75
1-1/2" x 50 yd	80	051115-32902-9	13062-7010369514	27.95
1-1/2" x 50 yd	100	051115-37484-5	13062-7010295370	26.95
1-1/2" x 50 yd	120	051115-32969-2	13062-7010290409	37.95
1-1/2" x 50 yd	180	051115-32970-8	13062-7010369517	37.95
1-1/2" x 50 yd	240	051115-32982-1	13062-7100050575	37.95
1-1/2" x 50 yd	320	051115-37487-6	13062-7010369525	37.95

SHAVIV Mango II Long Reach Sets

"B" and "E" sets are popular for deburring holes, slots & edges. "B" holder can support all "B" blades and can be inserted axially or perpendicular to the holder. "E" holder is a heavier duty version of the "B" holder. "B" sets come with (1) B10 and (1) B20 Blade, Blade holder, Handle.

- "E" sets come with (1) E100, (1) E200 & (1) E300 blade, blade holder, handle
- "F" sets are excellent for chamfering and countersinking. "F" set comes with (1) F20 blade, blade holder, handle



Style	Description	Order No.	Sale Price
B Set	Mango B Set	12283-90056	\$9.95
E Set	Mango E Set	12283-90065	11.50
F Set	Mango F Set	12283-90071	35.95

Additional Blades

Style	Description	Order No.	Sale Price
B-10	Deburs in (1) direction	12283-29012	\$0.85/pc
B-20	Deburs in either direction	12283-29019	0.80/pc
B-30	Deburs inside and outside of hole simultaneously	12283-29023	1.10/pc
E100	Heavy Duty (1) direction	12283-29034	1.05/pc
E200	Heavy Duty use clockwise or counter-clockwise	12283-29040	1.15/pc
E300	Heavy Duty deburs inside and outside of hole simultaneously	12283-29042	1.25/pc
F12	Countersink for hole edges up to 0.47"	12283-29049	16.25/pc
F20	Countersink for hole edges up to 0.47"	12283-29050	21.95/pc
F30	Countersink for hole edges up to 1.18"	12283-29051	37.95/pc

3M Scotch-Brite™ 6" x 9" Hand Pads

- Superior alternative to steel wool, wire brushes, sandpaper and other non-woven products for cleaning or finishing tasks
- Very fine grade aluminum oxide abrasive cleans, finishes, grains, denibs and defuzzes
- Suitable for use in wood, metal, plastics, ceramics, porcelain, rubber or composites
- Reusable pad resists tearing, splintering, shredding, loading and will never rust, providing a long useful life
- 20 Pieces per box



Size	Color	Order No.	Sale Price
6" x 9"	Maroon	11965-7000000728	\$31.95/box

WIDIN Single End Square & Ballnose 4-Flute End Mills

Regular Length/AlTiN Coated

- Center cutting
- Micro grain carbide end mills for enhanced tool life
- Great end mills for slotting and milling
- Best performance on carbon and alloy steels



Size	Flute Length	OAL	Square End Order No.	Sale Price	Ball End Order No.	Sale Price
1/16	3/16	1-1/2	11553-ZA304004	\$6.50	11553-ZB304004	\$7.75
3/32	5/16	1-1/2	11553-ZA304006	6.50	11553-ZB304006	7.75
1/8	1/2	2	11553-ZA304008	5.65	11553-ZB304008	7.50
5/32	9/16	2	11553-ZA304010	8.50	11553-ZB304010	10.25
3/16	5/8	2	11553-ZA304012	8.15	11553-ZB304012	9.65
7/32	5/8	2-1/2	11553-ZA304014	12.35	11553-ZB304014	14.50
1/4	3/4	2-1/2	11553-ZA304016	10.50	11553-ZB304016	13.75
5/16	13/16	2-1/2	11553-ZA304020	16.65	11553-ZB304020	19.95
3/8	1	3	11553-ZA304024	19.25	11553-ZB304024	25.25
7/16	1	3	11553-ZA304028	26.50	11553-ZB304028	31.65
1/2	1	3	11553-ZA304032	26.65	11553-ZB304032	38.50
9/16	1-1/8	3-1/2	11553-ZA304036	47.95	11553-ZB304036	50.45
5/8	1-1/4	3-1/2	11553-ZA304040	56.50	11553-ZB304040	69.95
3/4	1-1/2	4	11553-ZA304048	83.60	11553-ZB304048	102.75
1	1-1/2	4	11553-ZA304064	133.50	11553-ZB304064	161.95

wiha 40 Pc. TerminatorBlue Impact Bit Set

TerminatorBlue bits are impact rated for power tools and heat treated to produce a bit that lasts 120 times the service life compared to standard bits.

- TST - Torsion stabilizing technology for reduced tip stress and maximum flex torsion zone
- Minimum hardness tolerance of 61 RHC +/-1

Includes:

- **Phillips:** #1, #2, #3x25mm, #1, #2, #3x50mm, #2x89mm
- **Square:** #1, #2, #3x25mm, #1, #2x50mm, #3x89mm
- **Torx:** T15, T20, T25, T30 x25mm, T20, T25, T30, T40 x50mm, T20, T25, T30 x89mm
- **Nut Setter:** 5/16x76mm, 3/8x76mm
- **Bit Holder:** 1/4"x60mm



Order No.	Sale Price
11817-70297	\$27.95

wiha 6 Pc. SAE Color Coded Impact Nut Setters

- High visibility color coding for quick and easy size identification
- Impact rated to 700 in/lbs for max performance with impact drivers
- 6" overall length for extended reach
- Radius corners for preventing fastener head round off
- **Includes:** 1/4", 5/16, 3/8, 7/16, 1/2, 9/16



Order No.	Sale Price
11817-70486	\$47.65

wiha 39 Pc. Bits Collector Security Bit Set

- Through hardened, bits of CRM72 Premium tool steel
- Tip profile labeled on cap for easy identification
- Chrome plated satin finish for corrosion protection
- Exact fit precision machined tip for reduced cam-out

Includes:

- **Security Hex:** 5/64, 3/32, 7/64, 1/8, 9/64, 5/32
- **Security Torx:** T8, T10, T15, T20, T25, T27, T30, T40
- **Spanner:** #4, #6, #8, #10
- **Tri-Wing:** #1, #2, #3, #4
- **Torq:** #6 #8, #10
- **Square:** #1, #2, #3
- **Pozidrive:** #0, #1, #2, #3
- **Phillips:** #1, #2
- **Slotted:** 6.0, 8.0mm



Order No.	Sale Price
11817-71990	\$86.95

wiha 7 Pc. Precision Slotted & Phillips Screwdriver Set

Wiha precision screwdrivers feature comfortable handles sized proportionally to the blade for comfort precise control and direct molded to the blade for permanent bond. The driver tips profiles are labeled on the handles to quickly and easily identify the driver.

- Tapered handle for rapid rotation
- Smooth turning cap for optimal hand positions
- Premium quality tool steel for strength and durability
- Chrome plated satin finish for corrosion protection
- Exact fit precision machined tip for reduced cam-out

Includes:

- **Phillips:** #00, #0, #1
- **Slotted:** 1.5, 2.0, 2.5, 3.0mm

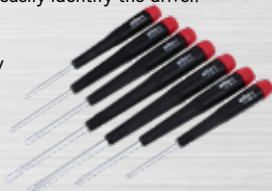

Order No.	Sale Price
11817-26197	\$30.25

wiha 32 Pc. GoBox™ Standard Bit Set with Mini Ratchet

Standard bit GoBox features a collection of 1" impact rated bits in a variety of tip profiles including Phillips, slotted, square, torx, hex-inch, hex-metric, and a 1/4" mini ratchet that can access tight spaces other tools can't.

- 72 tooth ratchet system with 5° arc swing for smooth ratcheting in tight spaces
- Conveniently stored in a pocket sized metal case for easy storage and security
- Computer controlled heat treatment for a new standard in bit performance
- Exact fit precision machined tips for reduced cam-out
- Fast action thumb lever for quick rotation change

Includes:

- **Phillips:** #0, #1, #2, #3
- **Slotted:** 5.5, 6.5mm
- **Square:** #1, #2
- **Torx:** T8, T10, T15, T20, T25, T27, T30
- **Hex Metric:** 2.0, 2.5, 3.0, 4.0, 5.0, 6.0mm
- **Hex Inch:** 1/16, 5/64, 3/32, 7/64, 1/8, 9/64, 5/32, 3/16



Order No.	Sale Price
11817-74984	\$27.95

wiha 19 Pc. Insulated SoftFinish® Slimline Blade Set

- Individually tested to 10,000 volts AC and rated to 1,000 volts AC for safety and peace of mind
- Ideal for jobs where access is limited
- Integrated Slim Insulation molded directly onto blade
- Standard 1/4" hex drive for universal application
- Wiha engineered premium quality tool steel for strength and durability

Includes:

- **Slotted and Pozidrive:** #1, #2
- **Slotted:** 3, 4, 5.5mm
- **Hex:** 3, 4, 5.0mm
- **Phillips:** #1, #2
- **Xeno:** #1, #2
- **Torx:** T8, T10, T15, T20
- **Square:** #1, #2



Order No.	Sale Price
11817-28398	\$143.65

wiha 12 Pc. SoftFinish® Torx Screwdriver Set

Wiha SoftFinish Cushion Grip Drivers are the standard for premium quality professional drivers featuring ergonomic cushion grip handles for comfort and control, dual durometer construction for long lasting durability, and handles are direct molded to blade for permanent bond. Additionally, SoftFinish® driver handles are sized proportionate to the blade for consistent mechanical advantage. Easily identifiable tip labeled on cap for easy identification

- Includes:** T5, T6, T7, T8, T9, T10, T15, T20, T25, T27, T30, and T40

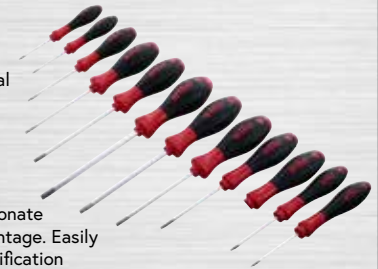

Order No.	Sale Price
11817-36267	\$83.95

wiha 44 oz. Dead Blow Hammer

The Dead Blow Hammer feature rugged malleable cast iron heads with a heavy duty, non-slip hickory handle.

- All steel head for incredible strength
- Durable hickory handles
- Filled with environmentally safe steel shot
- Replaceable polyurethane 50mm faces
- Faces are press fit and won't unscrew or loosen in use



Order No.	Sale Price
11817-80050	\$54.95

wiha 6 Pc. Insulated SoftFinish® Screwdriver Set - Slotted/Phillips

- Ergonomic cushion grip handles for comfort and control
- Handles are sized proportionately to the blade for consistent mechanical advantage
- Consists of premium quality tool steel for strength and durability, has black oxide finish for corrosion protection,
- Individually tested to 10,000 volts AC and rated to 1,000 volts AC for safety
- SoftFinish® cushion grip handle for comfort and control
- Tip profile labeled on cap for easy identification
- Made in Germany
- **Set includes:** Slotted: 3.5, 4.5, 6.5mm, Phillips: #1, #2, #3



Order No.	Sale Price
11817-32092	\$49.95

wiha 6 Pc. Torx Bit Socket Set - 1/4" Drive

- Spring loaded detent retaining ball for secure socket lock
- Push button quick release for rapid socket exchange
- Roll Stamp die markings for clear identification
- Knurled band for extra grip
- Broached and clear coated openings for corrosion and rust protection
- **Includes:** T10, T15, T20, T25, T27, T30



Order No.	Sale Price
11817-76194	\$29.95

Jergens 130MM 5-Axis Self-Centering Vise

Available in 160mm or 250mm lengths. **Clamping Force:** 3,600 lbs. @ 50 ft./lbs. Leadscrew features rolled trapezoidal threads for superior strength and durability. Low friction surface treatment of critical components improves performance and reduces wear. Includes reversible quick change jaws with serrated inserts.

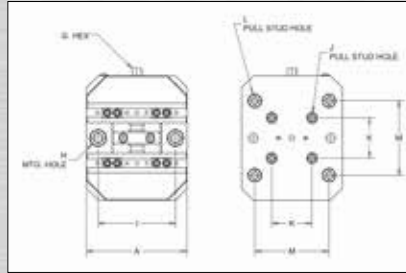
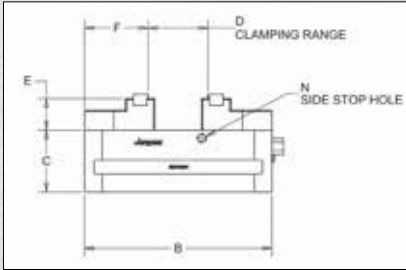

5CV13041-IN



5CV13045-IN

Width (mm)	Length (mm)	C (mm)	Clamping Range (mm)	E (mm)	F (mm)	G (mm)	H	I (mm)	J	K (mm)	L	M (mm)	N	Weight (kg)	Order No.	Sale Price
130	160	53	12-150	27	54	12	12mm QLS	100	QL-200800	52	QL-200805	96	M8x1.25	7.4	12336-5CV13041-IN	\$1,552.50
130	250	53	12-240	27	54	12	12mm QLS	100	QL-200800	52	QL-200805	96	M8x1.25	10.2	12336-5CV13045-IN	1,969.75

Jergens Dual Station Fixed Center Jaw

- Steel Machinable Soft Jaw
- Doubles workholding capacity on single vise
- By disengaging the pillow block and allowing the movable jaws to float, workpieces of different sizes can be clamped securely in both jaw openings

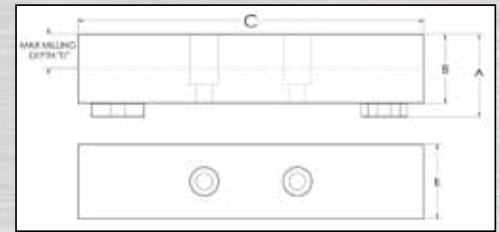

Compatibility	A (mm)	B (mm)	C (mm)	D (mm)	E (mm)	Order No.	Sale Price
5CV13041-IN, 5CV13045-IN	31	26	130	12.85	28	12336-5CV13041-DSSJ	\$131.25

Jergens Soft Jaw Sets

- High strength aluminum with blue anodize finish or low carbon steel with black oxide finish
- Set includes 2 jaws

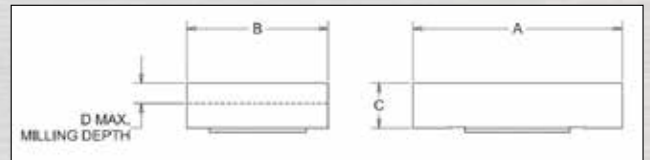
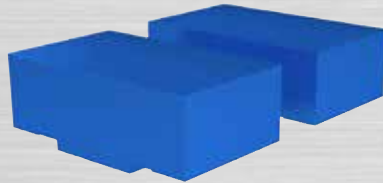

Vise Size	A (mm)	B (mm)	C (mm)	D (mm)	Material	Order No.	Sale Price
130	130	74	26	12	Aluminum	12336-5CV13041-ASJ	\$222.25
130	130	74	50	36	Aluminum	12336-5CV13041-ASJ-50	270.95
130	130	74	26	12	Steel	12336-5CV13041-SSJ	283.95
130	130	74	50	36	Steel	12336-5CV13041-SSJ-50	344.95

MOLDEX TouchFree EcoStation®



- Foam Disposable Earplugs
- Extra-soft, low pressure foam for comfort and fit
- Non-Irritating smooth surface
- NRR rating / 33dB

Model No.	Description	Pack Qty.	Order No.	Sale Price
6833	TouchFree EcoStation	500 Pair	15192-6833	\$131.65/kit
6704	Refill for 6833	500 Pair	15192-6704	76.50/refill

MOLDEX Glide® Foam Twist-In PlugStation®



- Foam twist-in earplugs are made of extra soft foam
- Their tapered shape fits easily in the ear canal and seals gently and snugly
- NRR rating 30dB

Model No.	Pack Qty.	Order No.	Sale Price
6883	150 Pair	15192-6883	\$102.85/kit

MOLDEX EcoStation® Earplug Dispenser



- Compliance - High visibility to increase awareness to your hearing conservation program
- Made in the USA

Model No.	Pack Qty.	Order No.	Sale Price
6703	500 Pair	15192-6703	\$80.85/kit

MOLDEX Magnetic Bracket for PlugStation®/EcoStation®

- Attach the magnetic bracket to any metallic surface
- Allows you to hang a PlugStation®/EcoStation® anywhere earplugs are needed



Model No.	Order No.	Sale Price
6868	15192-6868	\$14.95

MOLDEX Softies® Disposable Earplugs

- Radiant orange for easy compliance checks
- Tapered shape for easy insertion and removal
- Shaped to fit even very small ear canals
- Non-irritating smooth surface
- NRR rating / 33dB



Model No.	Pack Qty.	Order No.	Sale Price
6600	200 Pair	15192-6600	\$29.95/box

MOLDEX Glide® Soothers™ Twist-In Moisturizing Earplugs (with cord)

- Moisturizes for all day comfort
- Large stem handle on curved stem for easy insertion and removal
- Cord can be adjusted to any desired length
- NRR rating 31dB



Model No.	Pack Qty.	Order No.	Sale Price
6985	100 Pair	15192-6985	\$70.50/box

MOLDEX 7800 Series Reusable Silicone Half Mask Respirator

- Silicone has enhanced comfort and durability with higher resistance to heat and compression
- Sleek design for modern, high-tech look and increased worker acceptance
- Low profile, compact design fits well under welding helmets and with safety glasses
- Mask drops down for convenient storage around the neck or locks down for custom fit



Size	Order No.	Sale Price
Medium	15192-7802	\$35.95
Large	15192-7803	35.95

MOLDEX 9000 Series Reusable Full Face Respirator

- Exclusive over molded lens offers greater field of vision
- Light weight for superior all day comfort
- Lens stays away from flat surface when laid down to avoid scratching
- Lens meets ANSI Z87+ for high impact requirements



Size	Order No.	Sale Price
Medium	15192-9002	\$152.95
Large	15192-9003	152.95

MOLDEX Semi-Rectangular P100 Filter for 7000/7800/9000 Series Respirators

- Encased in Dura-Mesh® for durability and rough handling
- All Moldex filters are NIOSH certified at a level of 99.97% or greater against both oil and non-oil-based particulate aerosols
- Increased surface area mean longer service life and lower cost of ownership
- Enhanced airflow and breathability, Moldex's new P100 filters are a boost in comfort, wear and compliance.
- These filters can be used for the above Half and Full Face Respirators



Order No.	Sale Price
15192-7740	\$9.95

MOLDEX ADAPT Anti-Fog Safety Glasses

- Anti fog coating keeps vision clear with or without mask
- Toric lens shape for a closer fit
- Ultra-light construction with flexible soft grip temples
- Designed with UV filter and high anti-scratch coatings
- Meets the following standards: ANSI Z87.1; CSA Z94.3; and AS/NZS 1337.1



Model No.	Order No.	Sale Price
5002C-1	15192-5002C-1	\$9.25

MOLDEX AirWave N95 Particulate Respirator



- Exclusive easy breathing wave design
- Less resistance, better breathability
- Added carbon layer helps filter out nuisance levels of ozone and organic vapors
- Fits easily under welding hoods
- Easy adjust strap allows for a comfortable fit
- Full foam face seal for added comfort
- NIOSH certified to have a filter efficiency of 95% or greater for non-oil based particulates
- Meets heat and flame resistance in accordance with ANSI/ISEA 110-2009 Section 7.11.1
- 10 Masks per box

Model No.	Size	Order No.	Sale Price
4800	Medium/Large	15192-4800	\$64.95/box

MOLDEX AirWave M Series N95 Particulate Black Mask



- Exclusive easy breathing wave design
- Less resistance, better breathability
- FlexFit® design moves easily with your face and stays in place
- Soft, cloth SmartStrap is both hangable and adjustable
- Can be used against most welding fumes
- 10 Masks per box

Model No.	Size	Order No.	Sale Price
M4600	Medium/Large	15192-M4600	\$33.95/box

LOC-LINE 1/4" Hose Assembly Kit

- Compatible with all 1/4" system parts
- Threads directly into a 1/8" or 1/4" pipe thread supply
- Can be extended using additional segments
- Can accept male, female or in-line valves for video control
- Can be modified with "Y" elbows and nozzles to change shape and flow pattern



Includes: (1) ea. 1/8" NPT, 1/4" NPT
 (2) pc 1/4" segments 5-1/2" long
 (1) ea. 1/16" dia, 1/8" dia, 1/4" dia, round nozzles

Order No.	Sale Price
12728-40413	\$9.25

LOC-LINE 1/2" Hose Assembly Kit

- Compatible with all 1/2" system parts
- Threads directly into a 3/8" or 1/2" pipe thread supply
- Can be extended using additional 1/2" segments
- Can accept male, Female or in-line valves for video control
- Can be modified with "Y's, elbows, and nozzles to change shape and flow pattern



Includes: (1) Ea. 3/8" NPT, 1/2" NPT
 (2) Pc 1/2" segments 5-1/2" long
 (1) Ea. 1/4", 3/8", 1/2" Dia round nozzles

Order No.	Sale Price
12728-50813	\$10.75

LOC-LINE 1/4" Hose Segment Pack of 2

This segment pack provides (2) segments of 1/4" hose. Total assembled length is approximately 12"

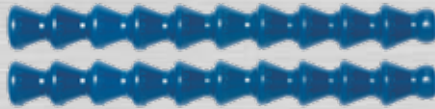

Order No.	Sale Price
12728-41401	\$6.95

LOC-LINE 1/2" Hose Segment Pack of 2

This segment pack provides (2) segments of 1/2" hose. Total assembled length is approximately 11"



Order No.	Sale Price
12728-51801	\$7.95

Wellsaw Model 1318-SA, 13" x 18" Bandsaw with Semi-Automatic Operation



The PLC controller (factory programmed) manages the raise and lower functions of the saw head and the open and close functions of the vise jaw in a programmed sequence. In high volume operations this increases productivity and reduces operator fatigue and error.

Features:

- PLC controlled, full cycle semi-automatic operation
- Powered frame raise
- Powered vise
- Variable hydraulic feed control
- Zero clearance carbide guides with rollers
- Double reduction gearbox w/ perimeter drive
- Complies with DOE small motor rule
- Infinitely variable blade speeds
- Quick adjust sawing force
- Rite-Tension® blade tensioning device
- Baldor Motor® - 3HP, 3PH TEFC
 - 2HP, Single Phase ODP

- Wet cutting system, flood type
- Powered blade brush
- 16" discharge table
- 110 volts at controls
- Overload and under-voltage protection
- Precision ground vise jaws
- Quick positioning vise
- Adjustable stock stop
- Auto shut off at the end of cut
- OSHA blade guarding
- Tiger-Tooth® Bi-metal blade
- Coolant for initial start up
- Voltage and motor has to be specified
- Must Specify Electrics at the time of order



F.O.B. Ship Point

Blade Size	Blade Speed	Coolant System	Bed Height	Floor Area	Shipping Weight	Order No.	Sale Price
12'6" x 1" x .035"	70-375 SFPM	Tank Capacity 8 Gallons	29"	40"W x 84"L	955 lbs.	11778-1318-SA	\$17,750.00



8" Industrial Bench Grinder

Built to withstand the high volume demands for even the busiest shops. These high quality machines grind, sharpen and smooth with equal precision and flawless results. CSA/CUS Certified and OSHA compliant.

- Adjustable safety shields
- Adjustable tool rest
- Heavy Duty capacitor motor
- Pre-drilled bases for mounting on stands or work benches
- Sealed bearings for maintenance free grinding
- Toggle switch with safety key
- Weight - 64 lbs



F.O.B. Ship Point

Size	HP	Phase	Voltage	Shaft Size	Wheel Size	Dust Port Size	Order No.	Sale Price
8"	1HP	1 Phase	115V	5/8"	8" x 1"	2-1/2"	12887-JT9-578008	\$446.95



20" Disc Sander

Direct drive motor to disc for maximum efficiency, with a hand activated brake for quick stoppage of disc for maximum efficiency. Extra large sanding surface, adjustable tilting work table, and sturdy cast iron base. The swing away guard makes changing abrasive discs quick and easy.

- 20" sanding disc for larger capacity
- Forward and reverse switch
- Miter gauge for angle sanding
- Disc brake slows the machine quickly and will activate immediately to stop machine in an emergency
- Tilting table allows bevel sanding



F.O.B. Ship Point

Size	HP	Phase	Voltage	Dust Port Size	Order No.	Sale Price
20"	3HP	3 Phase	230/460V	4"	12886-PM9-1791264	\$3,299.95



Combination Belt/Disc Sander

Full cast iron construction for heavy duty work. The articulating table mounted on the 6" x 48" belt sander head can be used vertically, horizontally, or angled to accommodate diverse jobs. The belt head has an indexing pin with stops at 0°, 45°, and 90° and the head lock allows use at any angle in between. Removing the top guard allows contour sanding.

- 460V operation requires an additional 460V magnetic switch (part number 31A-MSA-2)
- Belt and disc tables are precision ground cast iron with miter slots for precision and rigidity



F.O.B. Ship Point

Belt Size	Disc Size	HP	Dust Port Size	Disc Speed	Order No.	Sale Price
6" x 48"	12"	2HP	4"	2,375 RPM	12886-PM9-1791292K	\$2,199.50

Clausing 8027J - Clausing/Colchester Geared Head Lathe

The extra heavy-duty wide bed gives our machines the capability of withstanding heavy use and excellent durability with minimum maintenance. This model features 12 different spindle speeds, making it ideal for versatile, consistent use.

- All headstock gears are hardened and ground
- Headstock shafts are splined and turn on anti-friction bearings
- Broad range of feed and thread selections are available by using three selector levers and an 8 position rotary dial
- Cross slide runs along a dovetail guide
- Precision tapered roller spindle bearings
- Chuck guard, full splash guard and leadscrew cover
- Ability to reverse leadscrew while chuck is turning for faster thread-cutting
- One year warranty backed by the Clausing Service Center
- **Longitudinal Feed Range:** 0.001/0.080 (in/rev)
- **Cross Feed Range:** 0.0005 - 0.040 (in/rev)



F.O.B. Ship Point

Spindle	Swing Over Bed	Swing Over Cross Slide	Swing in Gap	Distance Between Centers	Bed Width	Spindle Bore	No. of Spindle Speeds	Spindle Speed Range	Cross Slide Travel	Top Slide Travel	Tailstock Quill Travel	Tailstock Quill Dia.	Voltage	Phase	Order No.	Sale Price
Phase	13"	8.26"	18.8"	40"	8"	1.57"	12	40-2500 RPM	7-1/2"	3.63"	4.38"	1.63"	230/460	3	12042-8027J	\$18,740.00



Precision ER Collets - Inch

- For use with milling, drilling, tapping or boring operations
- Average .0002" T.I.R.
- Clamping range: .039"

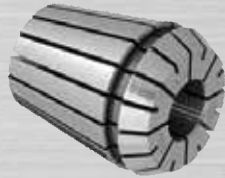

Range	Max. Shank	Order No.	Sale Price
ER11			
.043-.062	1/16	10897-04211-1/16	\$18.95
.054-.093	3/32	10897-04211-3/32	18.95
.086-.125	1/8	10897-04211-1/8	15.50
.117-.156	5/32	10897-04211-5/32	15.50
.148-.187	3/16	10897-04211-3/16	15.50
.179-.218	7/32	10897-04211-7/32	15.50
.211-.250	1/4	10897-04211-1/4	15.50
.242-.281	9/32	10897-04211-9/32	18.95
ER16			
.043-.062	1/16	10897-04216-1/16	21.50
.054-.093	3/32	10897-04216-3/32	16.50
.086-.125	1/8	10897-04216-1/8	16.50
.117-.156	5/32	10897-04216-5/32	16.50
.148-.187	3/16	10897-04216-3/16	16.50
.179-.218	7/32	10897-04216-7/32	16.50
.211-.250	1/4	10897-04216-1/4	16.50
.242-.281	9/32	10897-04216-9/32	16.50
.273-.312	5/16	10897-04216-5/16	16.50
.304-.343	11/32	10897-04216-11/32	16.50
.336-.375	3/8	10897-04216-3/8	16.50
.367-.406	13/32	10897-04216-13/32	16.50
ER20			
.043-.062	1/16	10897-04220-1/16	21.50
.054-.093	3/32	10897-04220-3/32	21.50
.086-.125	1/8	10897-04220-1/8	17.95
.117-.156	5/32	10897-04220-5/32	17.95
.148-.187	3/16	10897-04220-3/16	17.95
.179-.218	7/32	10897-04220-7/32	17.95
.211-.250	1/4	10897-04220-1/4	17.95
.242-.281	9/32	10897-04220-9/32	17.95
.273-.312	5/16	10897-04220-5/16	17.95
.304-.343	11/32	10897-04220-11/32	17.95
.336-.375	3/8	10897-04220-3/8	17.95
.367-.406	13/32	10897-04220-13/32	17.95
.398-.437	7/16	10897-04220-7/16	17.95
.429-.468	15/32	10897-04220-15/32	17.95
.461-.500	1/2	10897-04220-1/2	17.95
ER25			
.054-.093	3/32	10897-04225-3/32	21.95
.086-.125	1/8	10897-04225-1/8	18.50
.117-.156	5/32	10897-04225-5/32	18.50
.148-.187	3/16	10897-04225-3/16	18.50
.179-.218	7/32	10897-04225-7/32	18.50
.211-.250	1/4	10897-04225-1/4	18.50
.242-.281	9/32	10897-04225-9/32	18.50
.273-.312	5/16	10897-04225-5/16	18.50
.304-.343	11/32	10897-04225-11/32	18.50
.336-.375	3/8	10897-04225-3/8	18.50
.367-.406	13/32	10897-04225-13/32	18.50
.398-.437	7/16	10897-04225-7/16	18.50
.429-.468	15/32	10897-04225-15/32	18.50
.461-.500	1/2	10897-04225-1/2	18.50
.492-.531	17/32	10897-04225-17/32	18.50
.523-.562	9/16	10897-04225-9/16	18.50
.554-.593	19/32	10897-04225-19/32	18.50
.586-.625	5/8	10897-04225-5/8	18.50
.617-.656	21/32	10897-04225-21/32	20.95
.648-.687	11/16	10897-04240-11/16	20.95
.679-.718	23/32	10897-04240-23/32	20.95
.711-.750	3/4	10897-04240-3/4	20.95
ER40			
.086-.125	1/8	10897-04240-1/8	20.95
.117-.156	5/32	10897-04240-5/32	20.95
.148-.187	3/16	10897-04240-3/16	20.95
.179-.218	7/32	10897-04240-7/32	20.95
.211-.250	1/4	10897-04240-1/4	20.95
.242-.281	9/32	10897-04240-9/32	20.95
.273-.312	5/16	10897-04240-5/16	20.95
.304-.343	11/32	10897-04240-11/32	20.95
.336-.375	3/8	10897-04240-3/8	20.95
.367-.406	13/32	10897-04240-13/32	20.95
.398-.437	7/16	10897-04240-7/16	20.95
.429-.468	15/32	10897-04240-15/32	20.95
.461-.500	1/2	10897-04240-1/2	20.95
.492-.531	17/32	10897-04240-17/32	20.95
.523-.562	9/16	10897-04240-9/16	20.95
.554-.593	19/32	10897-04240-19/32	20.95
.586-.625	5/8	10897-04240-5/8	20.95
.617-.656	21/32	10897-04240-21/32	20.95
.648-.687	11/16	10897-04240-11/16	20.95
.679-.718	23/32	10897-04240-23/32	20.95
.711-.750	3/4	10897-04240-3/4	20.95
.742-.781	25/32	10897-04240-25/32	20.95
.773-.812	13/16	10897-04240-13/16	20.95
.807-.843	27/32	10897-04240-27/32	20.95
.836-.875	7/8	10897-04240-7/8	20.95
.867-.906	29/32	10897-04240-29/32	20.95
.898-.937	15/16	10897-04240-15/16	20.95
.929-.968	31/32	10897-04240-31/32	20.95
.961-1.00	1	10897-04240-1	20.95

Range	Max. Shank	Order No.	Sale Price
ER32			
.043-.062	1/16	10897-04232-1/16	\$24.95
.054-.093	3/32	10897-04232-3/32	24.95
.086-.125	1/8	10897-04232-1/8	18.50
.117-.156	5/32	10897-04232-5/32	18.50
.148-.187	3/16	10897-04232-3/16	18.50
.179-.218	7/32	10897-04232-7/32	18.50
.211-.250	1/4	10897-04232-1/4	18.50
.242-.281	9/32	10897-04232-9/32	18.50
.273-.312	5/16	10897-04232-5/16	18.50
.304-.343	11/32	10897-04232-11/32	18.50
.336-.375	3/8	10897-04232-3/8	18.50
.367-.406	13/32	10897-04232-13/32	18.50
.398-.437	7/16	10897-04232-7/16	18.50
.429-.468	15/32	10897-04232-15/32	18.50
.461-.500	1/2	10897-04232-1/2	18.50
.492-.531	17/32	10897-04232-17/32	18.50
.523-.562	9/16	10897-04232-9/16	18.50
.554-.593	19/32	10897-04232-19/32	18.50
.586-.625	5/8	10897-04232-5/8	18.50
.617-.656	21/32	10897-04232-21/32	18.50
.648-.687	11/16	10897-04232-11/16	18.50
.679-.718	23/32	10897-04232-23/32	18.50
.711-.750	3/4	10897-04232-3/4	18.50



CAT 50 & 40 Precision

ER Toolholders

- Balanced to 25,000 RPM at G2.5
- T.I.R. 0.0001" Measured from taper to collet pocket
- PowerCoat nut included for 75% more clamping power
- Techniks holder comes with a complete lab report



Series	Gage Length	Max Shank	Nut Dia.	Order No.	Sale Price
CAT 40 - HEX NUT					
ER11	3"	.275	0.748	10897-22213-3	\$121.95
ER16	2.76"	.406	1.08	10897-22225	120.95
ER16	4"	.406	1.08	10897-22227	123.50
ER16	6"	.406	1.08	10897-22231	134.75
ER16	8"	.406	1.08	10897-22233	151.95
ER16	10"	.406	1.08	10897-22233-10	186.50
ER20	2.76"	.512	1.34	10897-22235	121.95
ER20	4"	.512	1.34	10897-22237	120.95
ER20	6"	.512	1.34	10897-22239	141.95
ER20	10"	.512	1.34	10897-22239-10	186.50
CAT 40 - SLOTTED NUT					
ER25	2.5"	.630	1.65	10897-22243-2.5	121.95
ER25	2.76"	.630	1.65	10897-22243	121.95
ER25	4"	.630	1.65	10897-22245	131.50
ER25	6"	.630	1.65	10897-22247	134.75
ER25	8"	.630	1.65	10897-22251	151.95
ER25	10"	.630	1.65	10897-22253	131.50
ER32	2.76"	.788	1.97	10897-22255	130.75
ER32	6"	.788	1.97	10897-22257	147.95
ER32	8"	.788	1.97	10897-22259	164.50
ER32	10"	.788	1.97	10897-22259-10	186.50
ER40	3.15"	1.023	2.48	10897-22261	134.75
ER40	4"	1.023	2.48	10897-22263	131.50
ER40	6"	1.023	2.48	10897-22265	160.95
CAT 50 - HEX NUT					
ER16	4"	.406	1.08	10897-22281	147.95
ER16	6"	.406	1.08	10897-22285	160.95
ER16	8"	.406	1.08	10897-22287	211.50
ER20	4"	.512	1.34	10897-22291	151.95
ER20	6"	.512	1.34	10897-22293	151.95
ER20	8"	.512	1.34	10897-22295	211.50
CAT 50 - SLOTTED NUT					
ER25	4"	.630	1.65	10897-22303	143.50
ER25	6"	.630	1.65	10897-22305	159.95
ER25	8"	.630	1.65	10897-22307	211.50
ER25	9"	.630	1.65	10897-22307-9	504.95
ER32	4"	.788	1.97	10897-22311	143.50
ER32	6"	.788	1.97	10897-22313	168.95
ER32	8"	.788	1.97	10897-22317	190.50
ER40	4"	1.023	2.48	10897-22321	151.95
ER40	6"	1.023	2.48	10897-22325	177.95
ER40	8"	1.023	2.48	10897-22327	218.50



KURT DX6® Crossover® Vise



Combining all the great features of the world renowned Kurt D688 and 3600V vises, along with state of the art workholding features, Kurt® Workholding's revolutionary DX6® CrossOver® vise achieves new levels in precision and performance where flatness and parallelism are important.

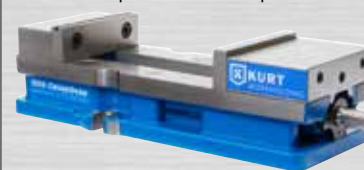

- Features the same bed height and keyway to the stationary jaw face as the D688
- Redesigned nut with lighter weight, and a new brush seal design
- Anglock® spherical segment creates all directional alignment and reduces jaw lift for improved performance.

Order No.	Sale Price
10094-DX6	\$659.95

SECO Square Shoulder Milling - Turbo 12 & 16 Kits

High Performance Milling in Larger Depth Applications

Turbo 12 is first-choice cutter for general-purpose square shoulder milling applications. The Turbo 12 is ideal in all applications from low carbon steels to high-temp alloys. Reduce your power consumption, improve wall quality, get higher performance in sticky materials and increase ramp angles with the latest insert and pocket design of the **Turbo 16** cutters.

P	Steel
M	Stainless Steel



Kit Description	Cutter	Dia.	Bore	Shank	Insert (10 pcs.)	No. of Pockets	Kit Contents		Order No.	Sale Price
							P	M		
R217/220.69-12 CUTTERS & XOMX/XOEX INSERTS - MAX PROFILING DEPTH OF CUT 0.433"										
TURBO 12 .750P KIT	R217.69-00.75-3-12-2AN	3/4	-	3/4	XOMX 120408TR-M12 MP2501	2	X		11886-02628260	\$409.50
TURBO 12 1.00P KIT	R217.69-01.00-3-12-3AN	1	-	1	XOMX 120408TR-M12 MP2501	3	X		11886-02628263	433.20
TURBO 12 1.25P KIT	R217.69-01.25-3-12-4AN	1-1/4	-	1-1/4	XOMX 120408TR-M12 MP2501	4	X		11886-02628266	438.90
TURBO 12 1.5P KIT	R220.69-01.50-12-4AN	1-1/2	-	1-1/2	XOMX 120408TR-M12 MP2501	4	X		11886-03019949	508.25
TURBO 12 .750M KIT	R217.69-00.75-3-12-2AN	3/4	-	3/4	XOEX 120408R-M07 F40M	2		X	11886-02628261	457.90
TURBO 12 1.00M KIT	R217.69-01.00-3-12-3AN	1	-	1	XOEX 120408R-M07 F40M	3		X	11886-02628264	463.60
TURBO 12 1.25M KIT	R217.69-01.25-3-12-4AN	1-1/4	-	1-1/4	XOEX 120408R-M07 F40M	4		X	11886-02628267	471.20
TURBO 12 1.50M KIT	R220.69-01.50-12-4AN	1-1/2	-	1-1/2	XOEX 120408R-M07 F40M	4		X	11886-03019952	537.75
R217/220.69-16 CUTTERS & XOMX INSERTS - MAX PROFILING DEPTH OF CUT 0.591"										
TURBO 16 1.00P KIT	R217.69-01.00-3-X016-2A	1	-	1	XOMX160508TR-M13 MP2501	2	X		11886-10084223	495.90
TURBO 16 1.25P KIT	R217.69-01.25-3-X016-3A	1-1/4	-	1-1/4	XOMX160508TR-M13 MP2501	3	X		11886-10084224	518.70
TURBO 16 1.50P KIT	R217.69-01.50-3-X016-3A	1-1/2	-	1-1/2	XOMX160508TR-M13 MP2501	3	X		11886-10084225	535.80
TURBO 16 2.00P KIT	R220.69-02.00-X016-5A	2	3/4	-	XOMX160508TR-M13 MP2501	5	X		11886-10084226	670.75
TURBO 16 2.50P KIT	R220.69-02.50-X016-5A	2-1/2	3/4	-	XOMX160508TR-M13 MP2501	5	X		11886-10084227	733.90
TURBO 16 3.00P KIT	R220.69-03.00-X016-6A	3	1	-	XOMX160508TR-M13 MP2501	6	X		11886-10084228	828.90
TURBO 16 1.00M KIT	R217.69-01.00-3-X016-2A	1	-	1	XOMX160508TR-ME11 F40M	2		X	11886-10084229	491.25
TURBO 16 1.25M KIT	R217.69-01.25-3-X016-3A	1-1/4	-	1-1/4	XOMX160508TR-ME11 F40M	3		X	11886-10084230	513.95
TURBO 16 1.50M KIT	R217.69-01.50-3-X016-3A	1-1/2	-	1-1/2	XOMX160508TR-ME11 F40M	3		X	11886-10084231	530.10
TURBO 16 2.00M KIT	R220.69-02.00-X016-5A	2	3/4	-	XOMX160508TR-ME11 F40M	5		X	11886-10084232	664.95
TURBO 16 2.50M KIT	R220.69-02.50-X016-5A	2-1/2	3/4	-	XOMX160508TR-ME11 F40M	5		X	11886-10084233	727.15
TURBO 16 3.00M KIT	R220.69-03.00-X016-6A	3	1	-	XOMX160508TR-ME11 F40M	6		X	11886-10084234	817.95

Kits include one cutter body, ten inserts and a wrench

SECO Face Milling High Feed 2 Kits

Gain Improved Economy in High Feed Milling

Machine up to three times faster than conventional methods. Pairing shallow depth of cut with high feed per tooth increases metal removal rates resulting in more parts being machined. The High Feed 2 comes in two insert sizes and is single sided. The diameter range begins as small as 0.500" and is excellent in all materials

P	Steel
M	Stainless Steel



Kit Description	Cutter	Dia.	Bore	Shank	Insert (10 pcs.)	No. of Pockets	Kit Contents		Order No.	Sale Price
							P	M		
HIGHFEED2 .625P KIT	R217.21-0.625.0-LP06.2A	5/8	-	5/8	LPHW 060310TR-MD07 MP2501	2	X		11886-02874480	\$359.10
HIGHFEED2 .750P KIT	R217.21-0.75.0-LP06.2A	3/4	-	3/4	LPHW 060310TR-MD07 MP2501	2	X		11886-02874481	373.35
HIGHFEED2 1.00P KIT	R217.21-1.00.0-LP06.3A	1	-	1	LPHW 060310TR-MD07 MP2501	3	X		11886-02874482	409.50
HIGHFEED2 .625P KIT	R217.21-0.625.0-LP06.2A	5/8	-	5/8	LPHT 060310TR-M06 F40M	2		X	11886-02874483	359.10
HIGHFEED2 .750P KIT	R217.21-0.75.0-LP06.2A	3/4	-	3/4	LPHT 060310TR-M06 F40M	2		X	11886-02874484	373.35
HIGHFEED2 1.00P KIT	R217.21-1.00.0-LP06.3A	1	-	1	LPHT 060310TR-M06 F40M	3		X	11886-02874516	409.50



MICHIGAN LOCATION:
13870 Cavaliere Drive
Shelby Township, MI 48315
586-803-3163

KENTUCKY LOCATION:
2041 Clay Street
Henderson, KY 42420
270-888-7001

Connect with us  

PRICES EXPIRE JUNE 30, 2024

Due to the volatility of current market conditions, we reserve the right to update these published flyer prices without warning. We will do everything within our capabilities to honor these flyer prices, but please understand that there may be circumstances that prevent us from being able to do so.